

**SUPPORTING DOCUMENT
1997 FIRM FLOOD INSURANCE RATE MAP**

Attached is the 1997 FIRM Flood Insurance Rate Map for the Property. The map does not consider the relocation of Old McHenry to its current configuration. Lake County Stormwater Management Commission has advised that there are no floodplains or special hazards on the property. However the site capacity calculations included with this application include the floodplain area depicted on the attached map (approximately 0.57 acres)

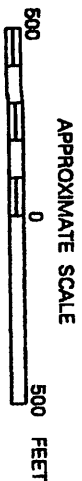
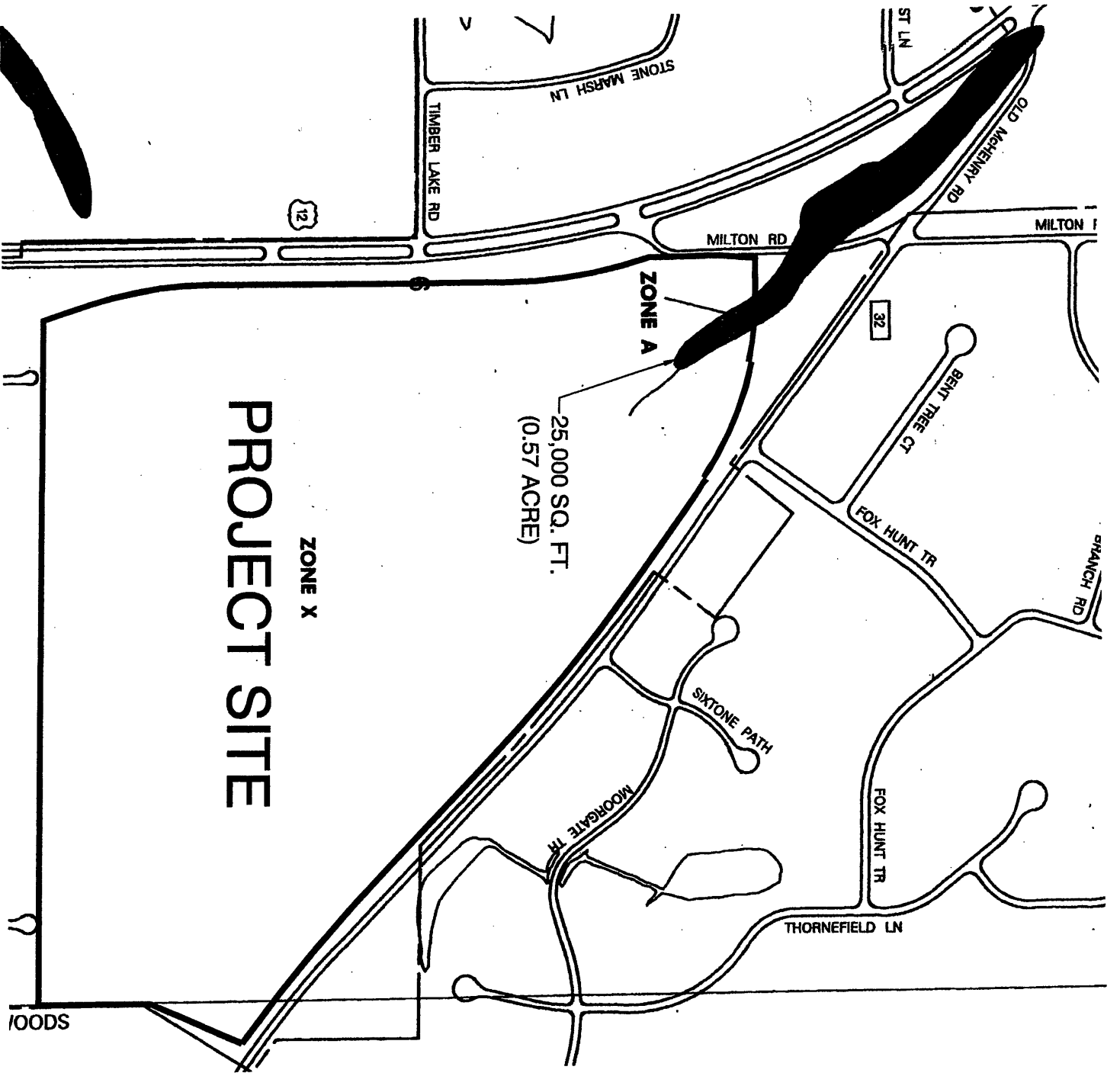

NATIONAL FLOOD INSURANCE PROGRAM

**FIRM
FLOOD INSURANCE RATE MAP
LAKE COUNTY,
ILLINOIS
AND INCORPORATED AREAS**

PANEL 226 OF 295

(SEE MAP INDEX FOR PANELS NOT PRINTED)

CONTAINS:

COMMUNITY	NUMBER	PANEL	SUFFIX
WANTHORN WOODS, VIL. OF	170286	0226	F
LAKE COUNTY	170287	0226	F
NORTH BARRINGTON, VIL. OF	170283	0226	F

Notes to Users: The MAP NUMBER shown below should be used when placing map orders; the COMMUNITY NUMBER shown above should be used on insurance applications for the subject community.

MAP NUMBER
709700226 F

EFFECTIVE DATE:
SEPTEMBER 3, 1997



Federal Emergency Management Agency